

Courses and Distances
down French Creek from a Birch

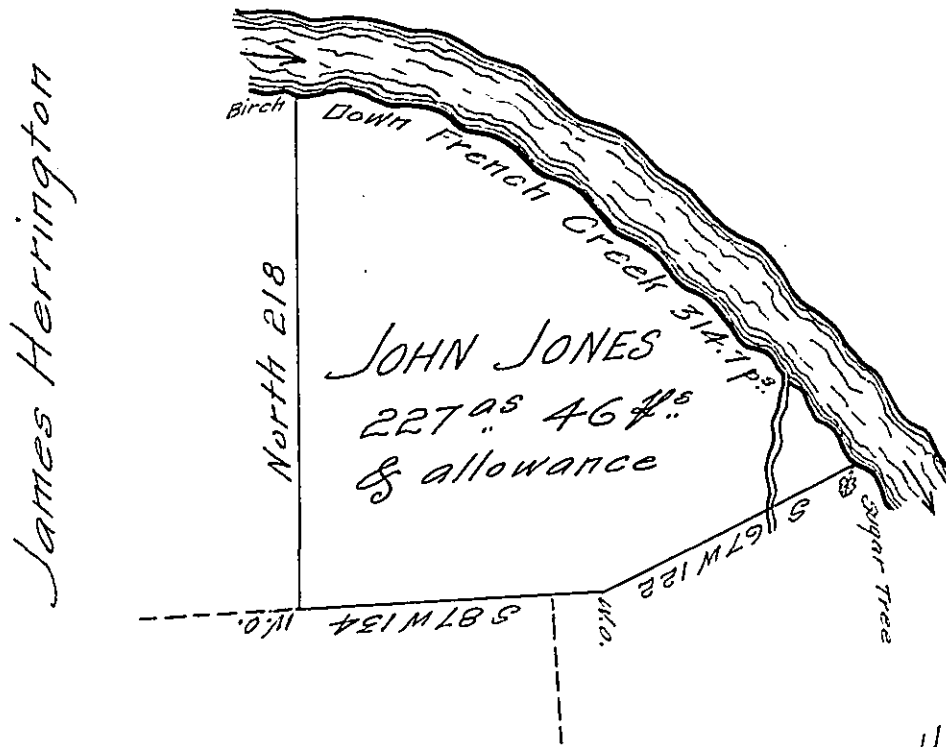

S 87° E	38.6
S 86° E	25
S 72½ E	56
S 51½ E	16.8
S 48° E	116
S 38¼ E	10.7
S 30° E	39
S 19° E	12.6
to a Sugar Tree	
	<hr/>
	314.7 —

John Rice
John Hall

Situate on the West side of French Creek in Allegheny County Containing 227 as 46 ps and allowance of Six Per Cent for Roads & C. Surveyed the 15th day of May 1795 In pursuance of his Improvement Bearing date the 1st Day of April 1795.

W^m Power D^y Sr.

To Daniel Brodhead Esquire
Surveyor General

IN TESTIMONY that the above is a copy of the original remaining on file in the Department of Internal Affairs of Pennsylvania, made conformably to an Act of Assembly approved the 16th day of February, 1833, I have hereunto set my Hand and caused the Seal of said Department to be affixed at Harrisburg, this thirteenth day of September 1906

Leach N. Brown
Secretary of Internal Affairs.